

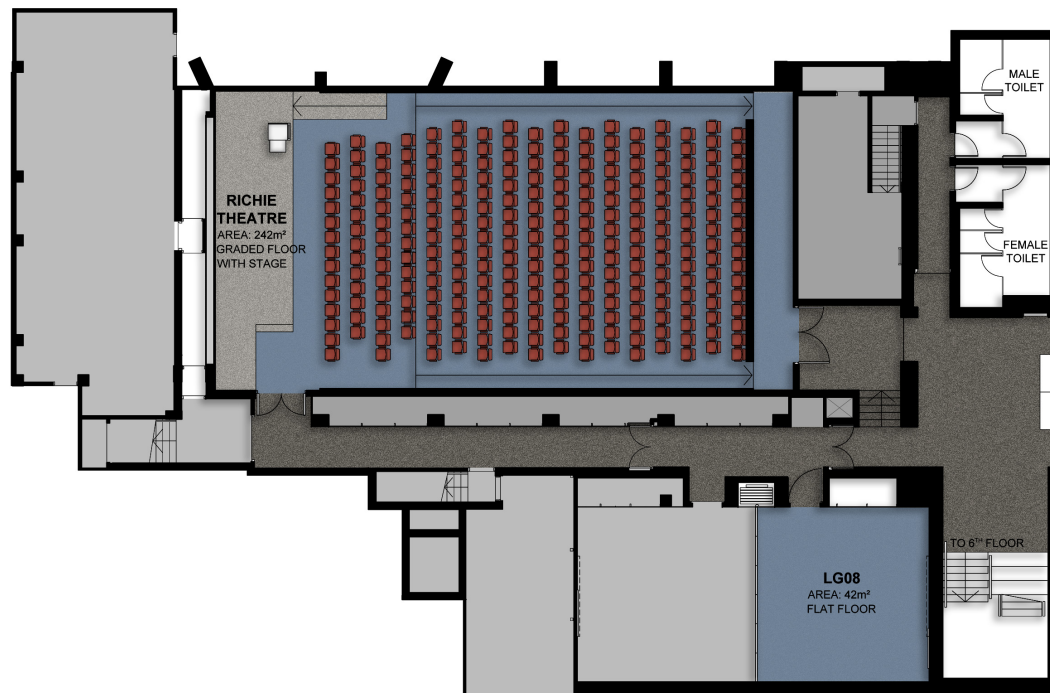

JOHN NILAND SCIENTIA:  
LOWER GROUND FLOOR

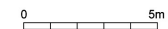

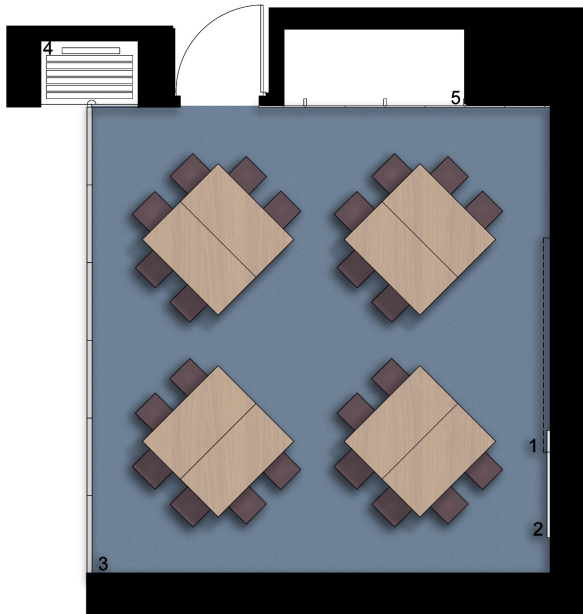

01 - CLUSTERED OPTION  
SEATING CAPACITY: 24

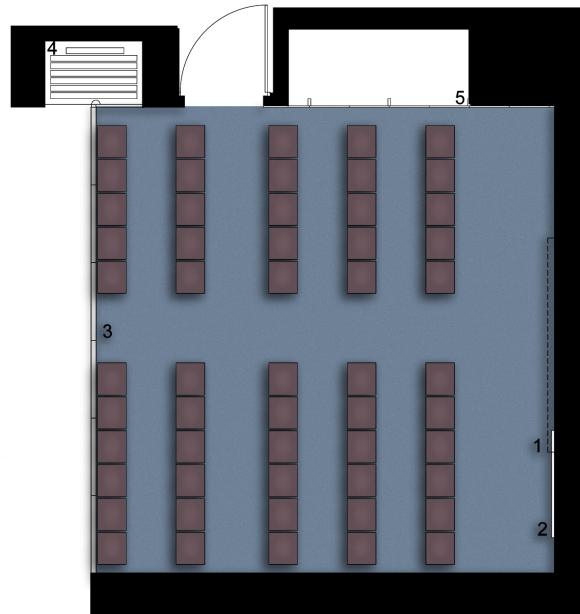

02 - THEATRE OPTION  
SEATING CAPACITY: 55

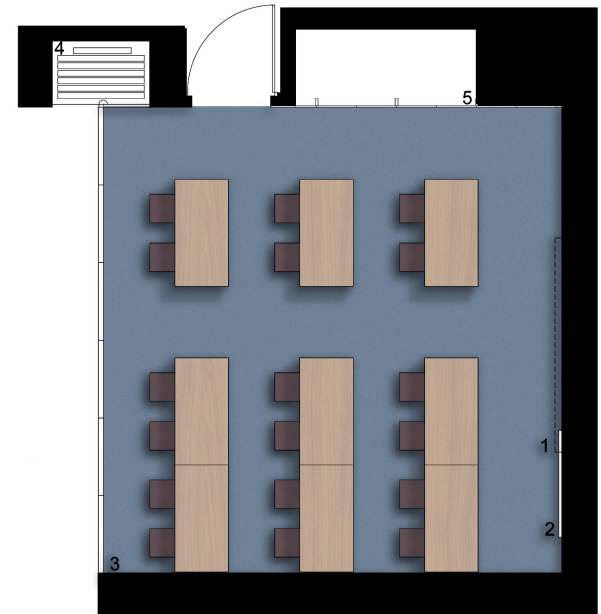

03 - CLASSROOM OPTION  
SEATING CAPACITY: 18

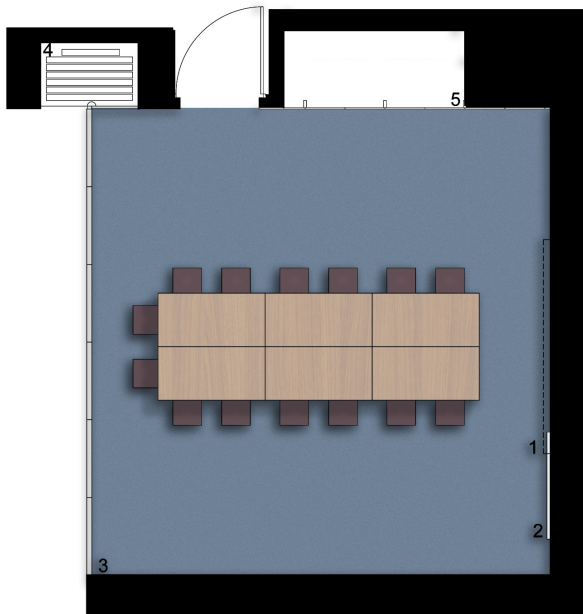

04 - BOARDROOM OPTION  
SEATING CAPACITY: 14

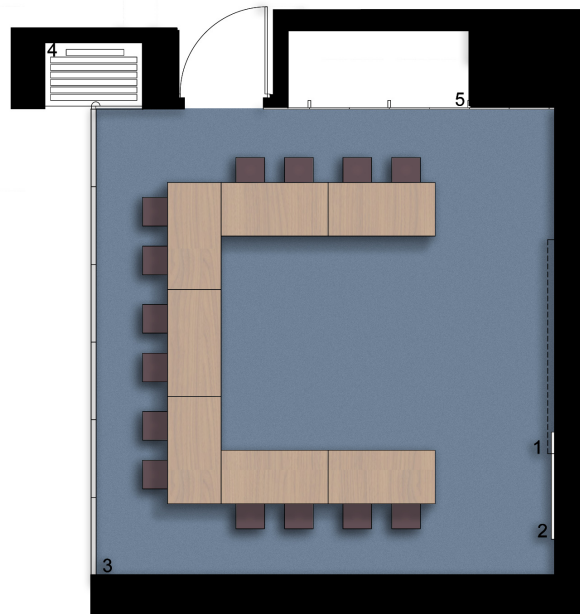

05 - U-SHAPE OPTION  
SEATING CAPACITY: 14

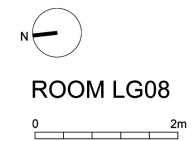

- ROOM LG08
1. RETRACTABLE PROJECTOR SCREEN
  2. FIXED WHITEBOARD ON WALL
  3. SOLID STACKABLE WALL PANELS
  4. SOLID STACKABLE WALL PANELS (STACKED POSITION)
  5. STORAGE

INTERNAL AREA : 42m<sup>2</sup>



# RICHIE THEATRE

0 2.5m

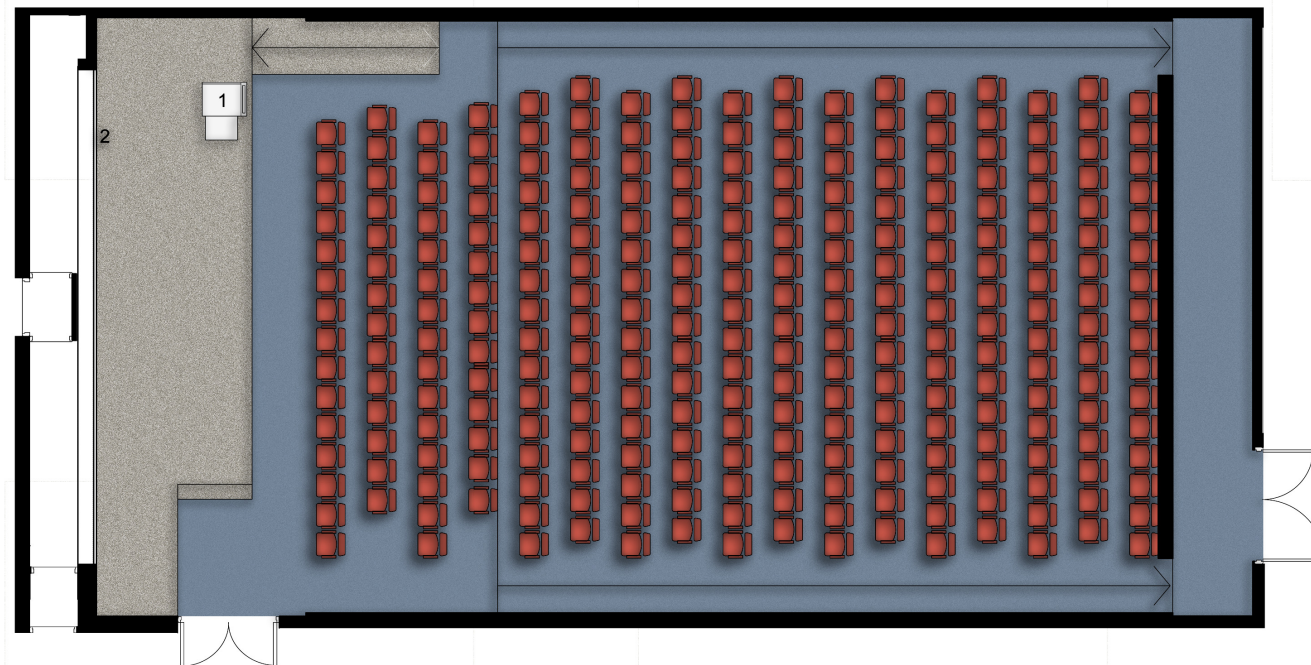

1. FIXED LECTURN
2. RETRACTABLE PROJECTOR SCREEN

INTERNAL AREA :242m<sup>2</sup>  
MAX SEATING CAPACITY :266





JOHN NILAND SCIENTIA:  
GROUND FLOOR

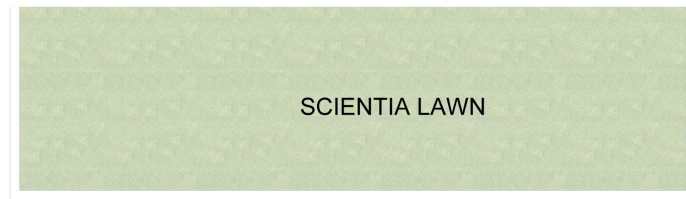

↑  
BOTANY ROAD  
GATE II

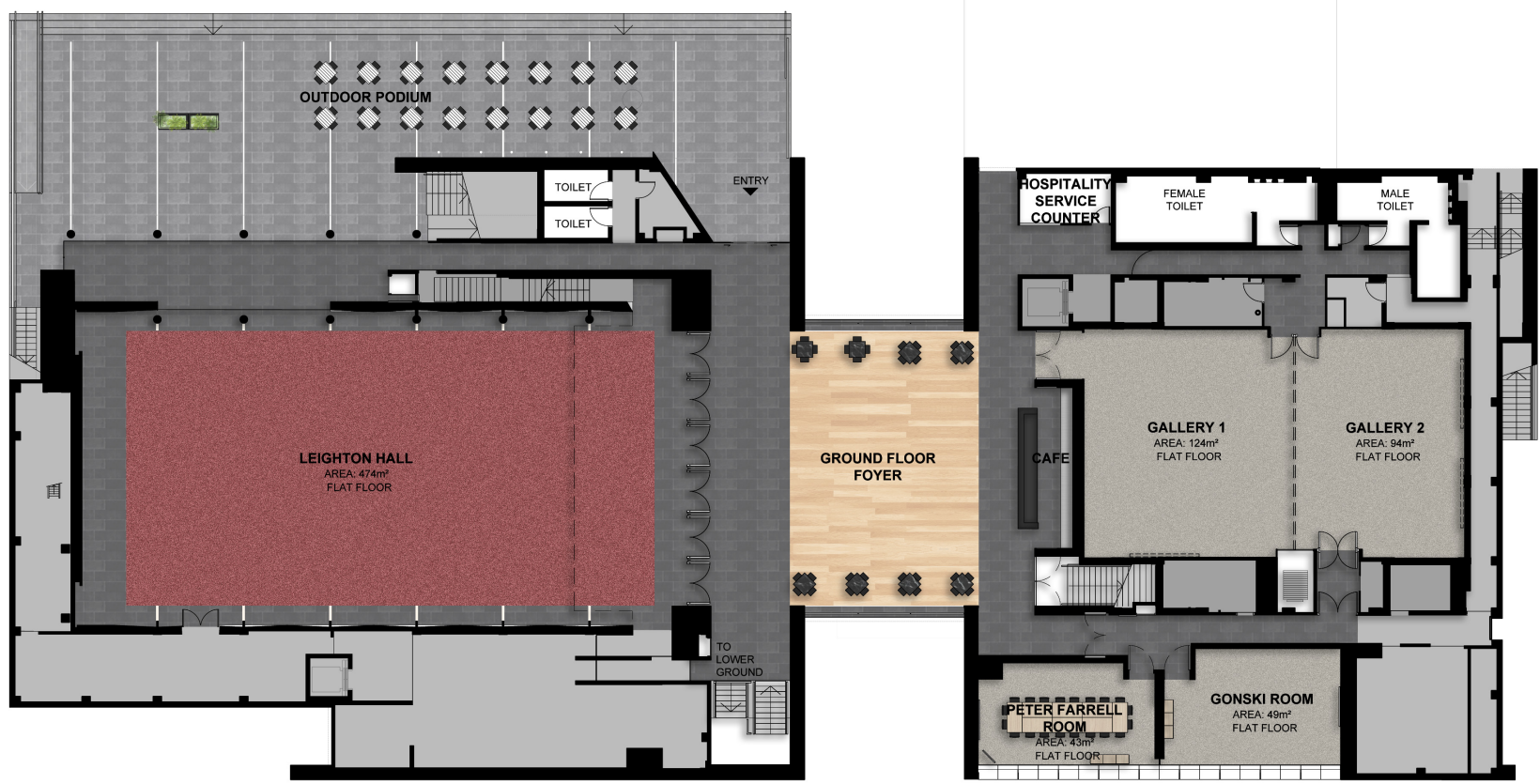
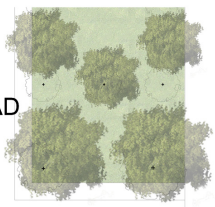





GALLERY 1 & 2

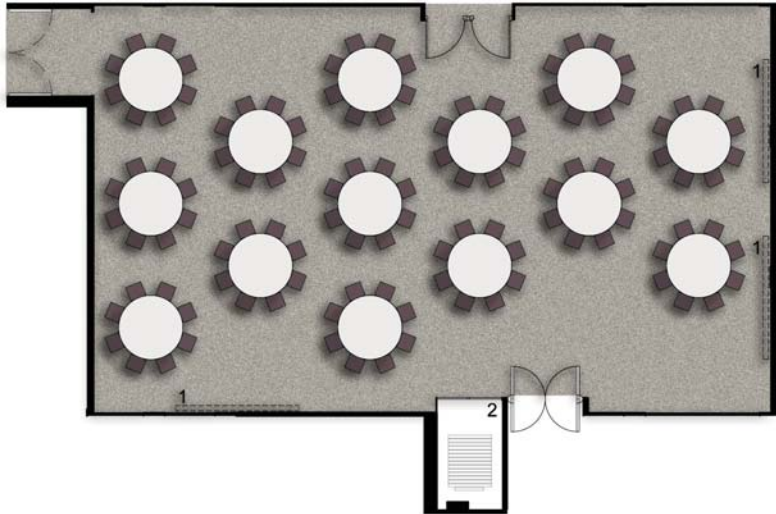

01 - DINING OPTION 01  
SEATING CAPACITY: 140

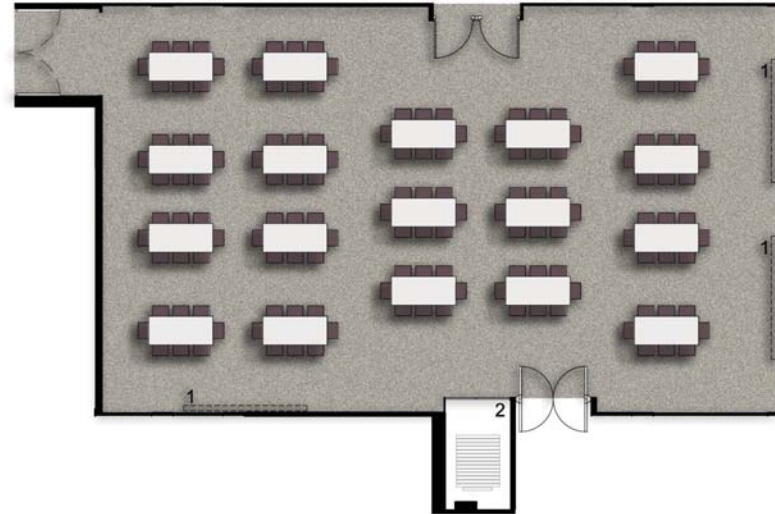

02 - DINING OPTION 02  
SEATING CAPACITY: 144

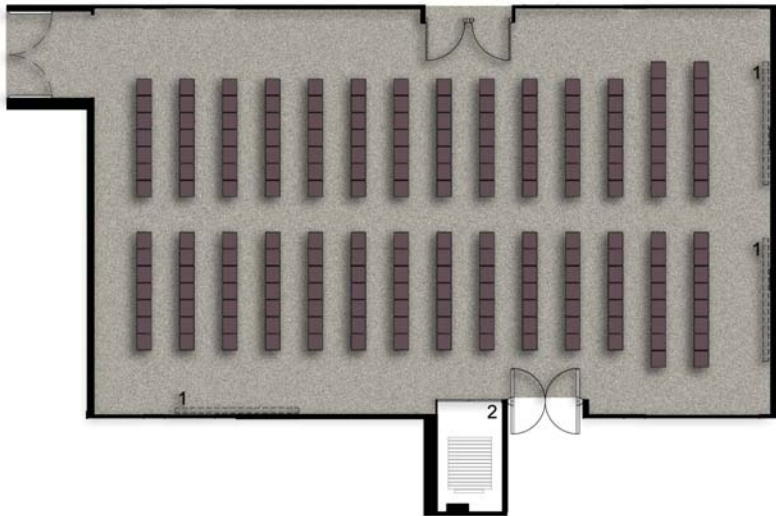

03 - THEATRE OPTION  
SEATING CAPACITY: 200

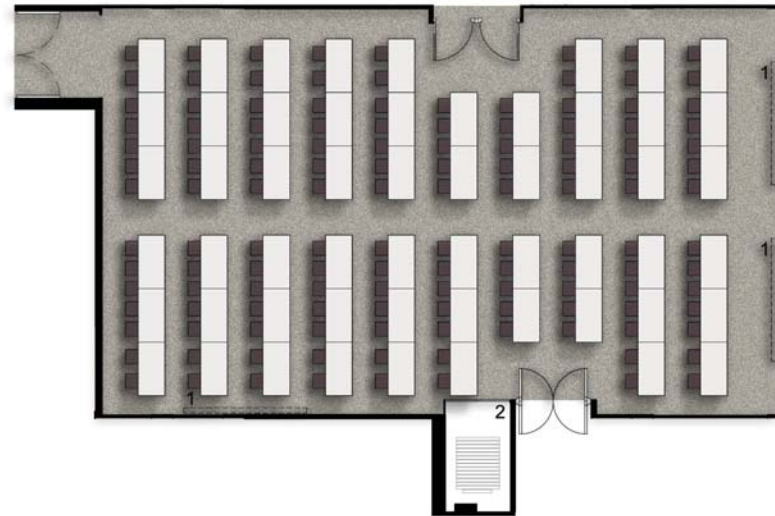

04 - CLASSROOM OPTION  
SEATING CAPACITY: 132

- 1. RETRACTABLE PROJECTOR SCREEN
- 2. SOLID STACKABLE WALL PANELS (STACKED POSITION)

INTERNAL AREA : 218m<sup>2</sup>



GONSKI ROOM

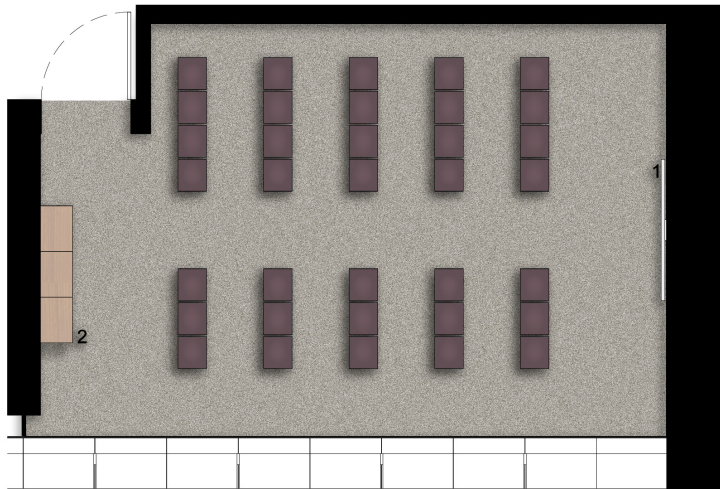
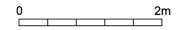

01 - THEATRE OPTION  
SEATING CAPACITY: 35

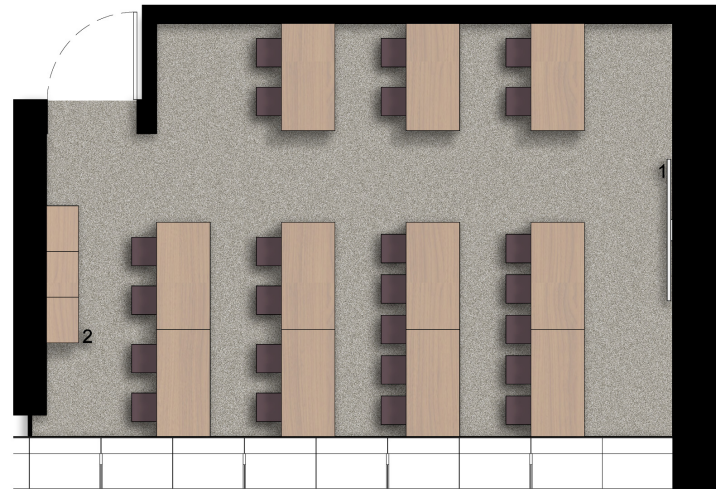

02 - CLASSROOM OPTION  
SEATING CAPACITY: 24

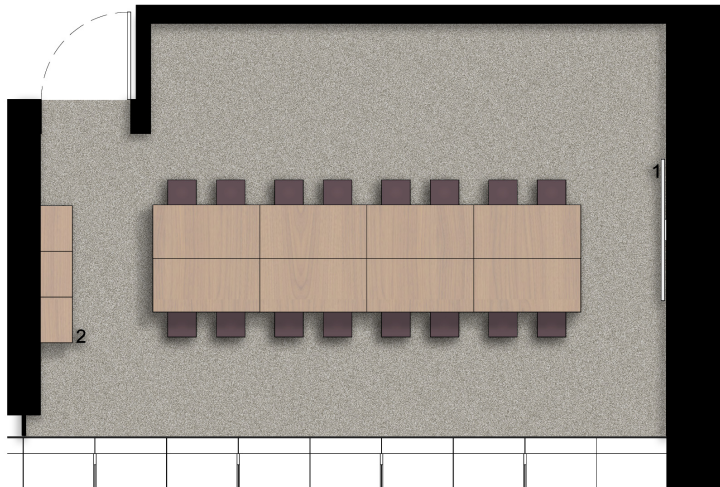

03 - BOARDROOM OPTION  
SEATING CAPACITY: 16

- 1. FIXED TV
- 2. FREE STANDING CRENZNA

INTERNAL AREA :49m<sup>2</sup>



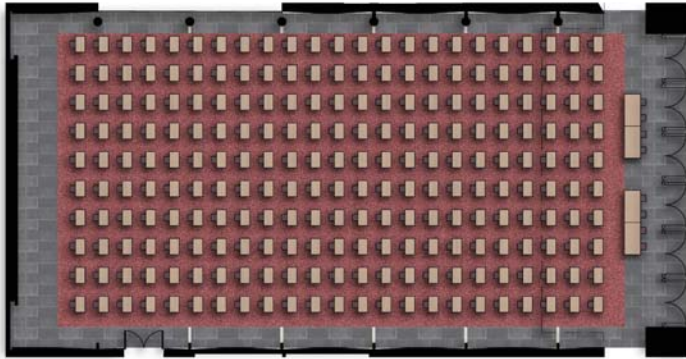

01 - EXAM OPTION  
SEATING CAPACITY: 230

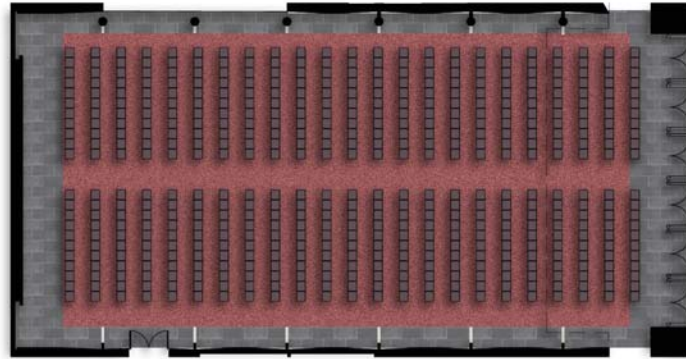

02 - THEATRE OPTION  
SEATING CAPACITY: 506

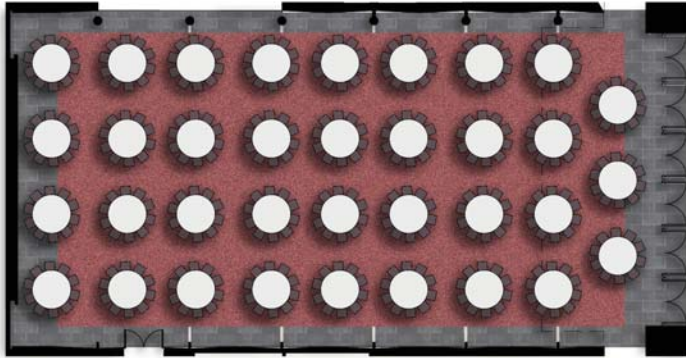

03 - DINING OPTION 01  
SEATING CAPACITY: 350

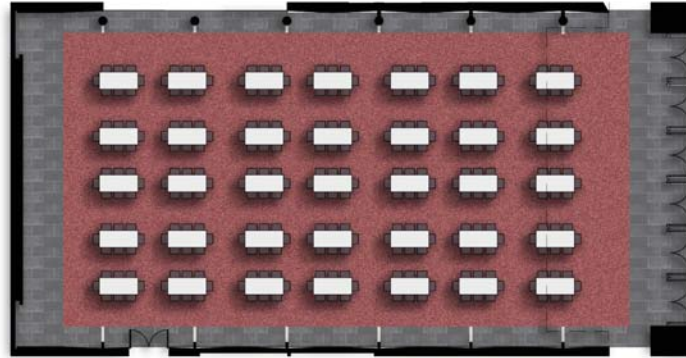

04 - DINING OPTION 02  
SEATING CAPACITY: 280

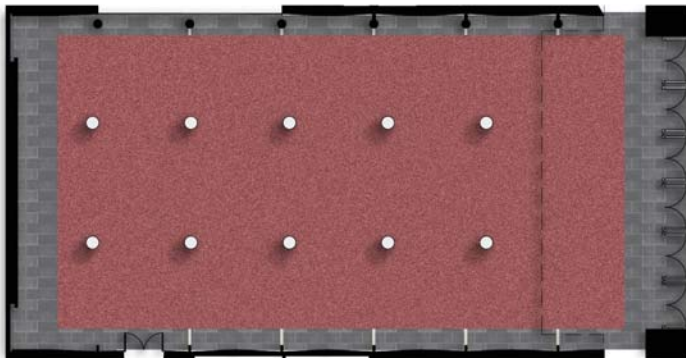

06 - COCKTAIL OPTION  
GUEST CAPACITY: 500



LEIGHTON HALL



INTERNAL AREA : 474m<sup>2</sup>





# OUTDOOR PODIUM

0 5m



AREA : 338m<sup>2</sup>  
SEATING CAPACITY : 64



## PETER FARRELL ROOM

0 2m

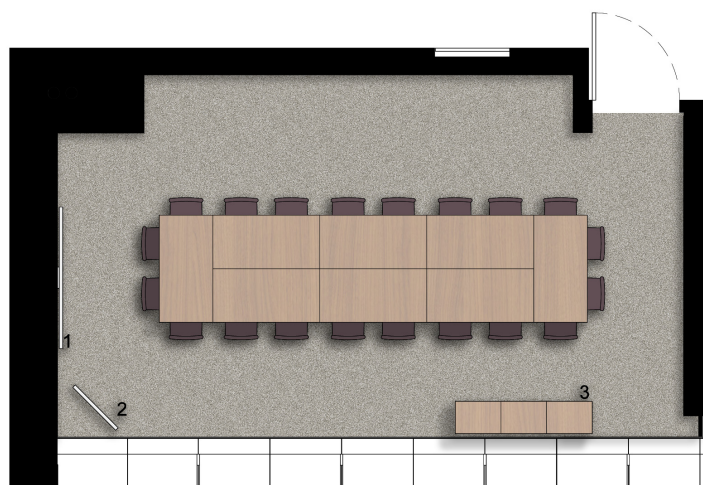

1. FIXED TV
2. FREE STANDING WHITEBOARD
3. FREE STANDING CREDENZA

INTERNAL AREA : 43m<sup>2</sup>  
SEATING CAPACITY : 20



TYREE ROOM &  
ALUMNI TERRACE

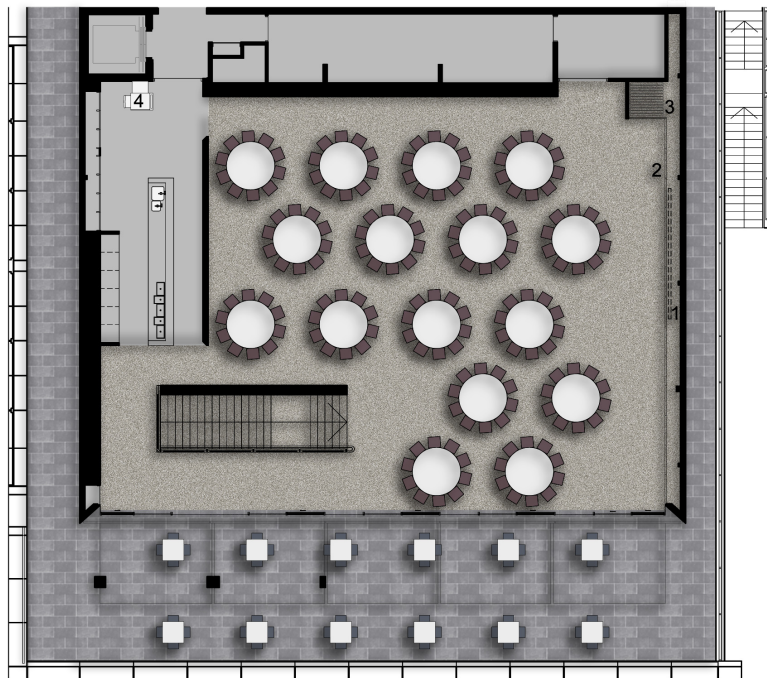

01 - DINING OPTION  
SEATING CAPACITY: 160

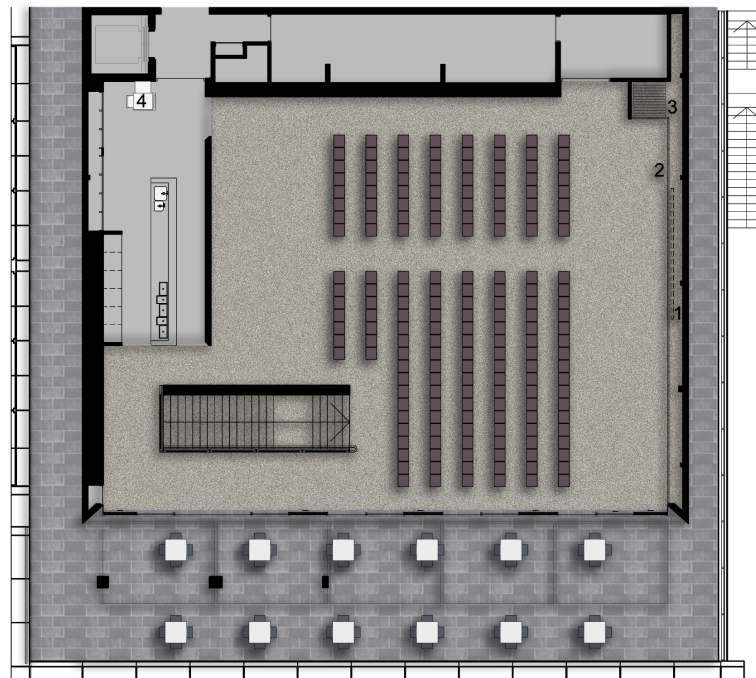

02 - THEATRE/PERFORMANCE OPTION  
SEATING CAPACITY: 180

1. FIXED PROJECTOR SCREEN
2. SOLID STACKABLE WALL PANELS
3. SOLID STACKABLE WALL PANELS (STACKED POSITION)
4. FIXED LECTURN

INTERNAL AREA : 310m<sup>2</sup>