

01 - CLUSTERED OPTION  
SEATING CAPACITY: 36

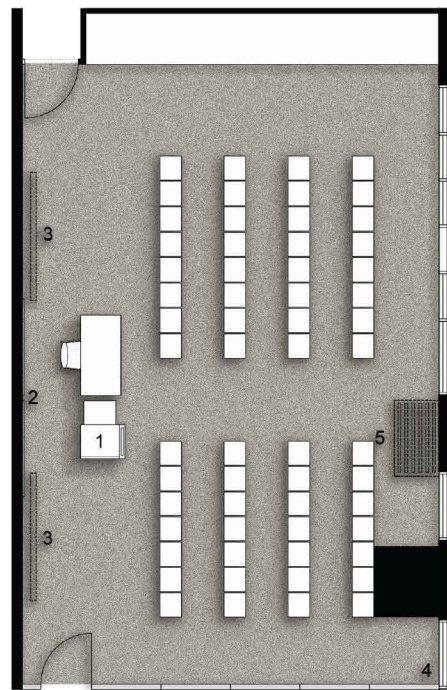

02 - THEATRE OPTION  
SEATING CAPACITY: 60

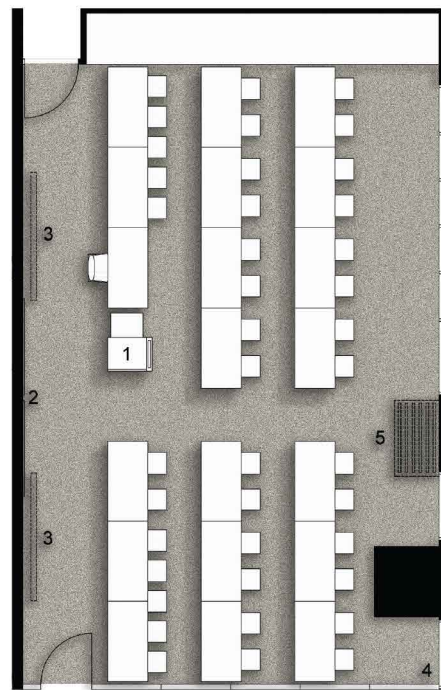

03 - CLASSROOM OPTION  
SEATING CAPACITY: 40

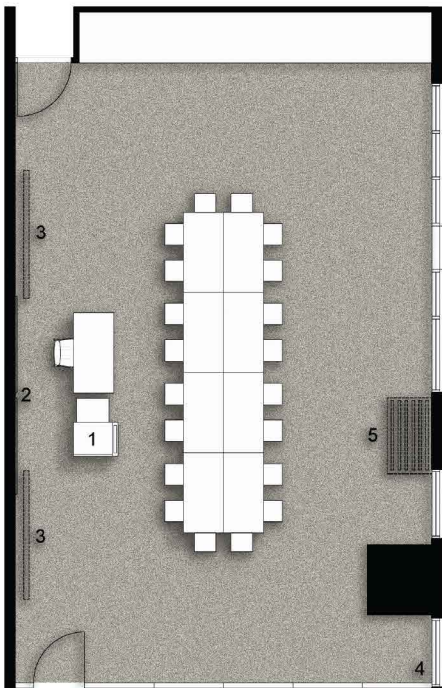

04 - BOARDROOM OPTION  
SEATING CAPACITY: 20

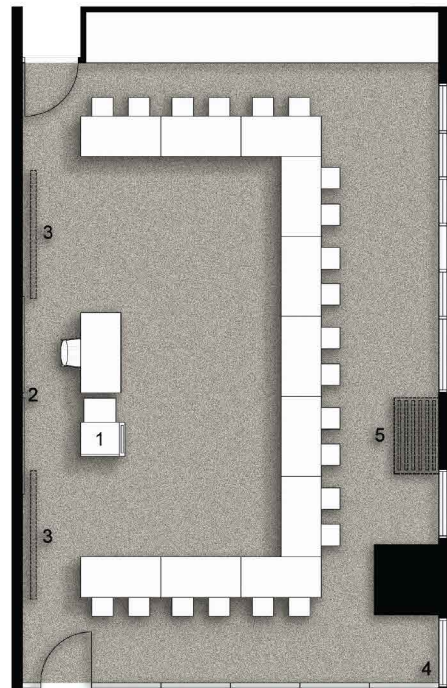

05 - U-SHAPE OPTION  
SEATING CAPACITY: 22



LEVEL 6 S4



1. FREESTANDING LECTURN AND FACILITATOR TABLE
2. FIXED WHITE BOARD
3. DUAL RETRACTABLE PROJECTOR SCREEN
4. SOLID MOVABLE WALL PANELS
5. LOCATION OF STACKED MOVABLE WALL PANELS

INTERNAL AREA: 89m<sup>2</sup>